

# Industrial - Floor Plan

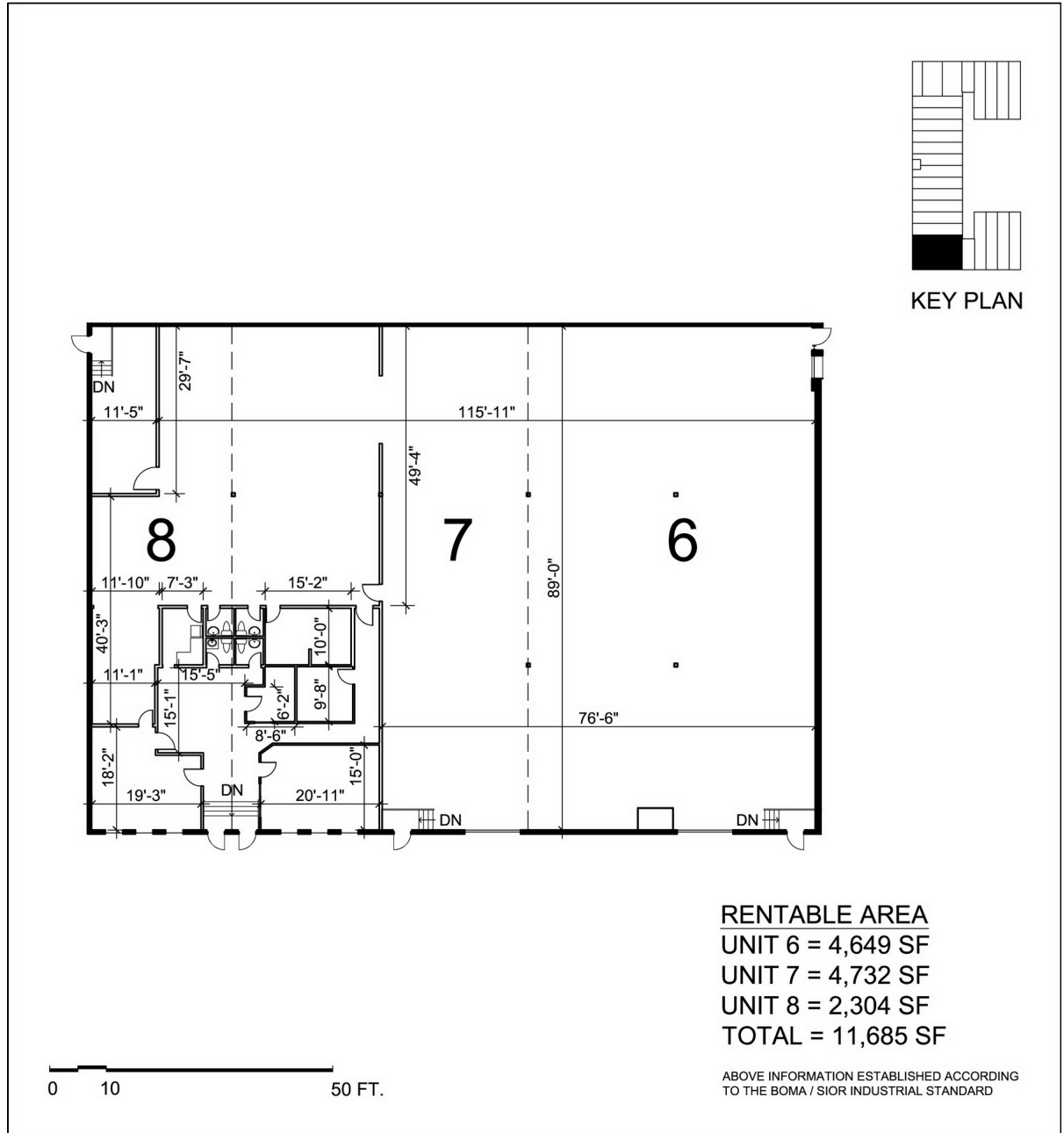

LOCATION:

**250 Rayette Rd.**  
**City of Vaughan**

Between Keele St. & Dufferin St. south of Langstaff Rd.



FOR MORE INFORMATION, PLEASE CONTACT:

**Gabrielle Mair**  
Director of Leasing

**905.669.9714**  
[gmair@metrusproperties.com](mailto:gmair@metrusproperties.com)