

Retail - Floor Plan

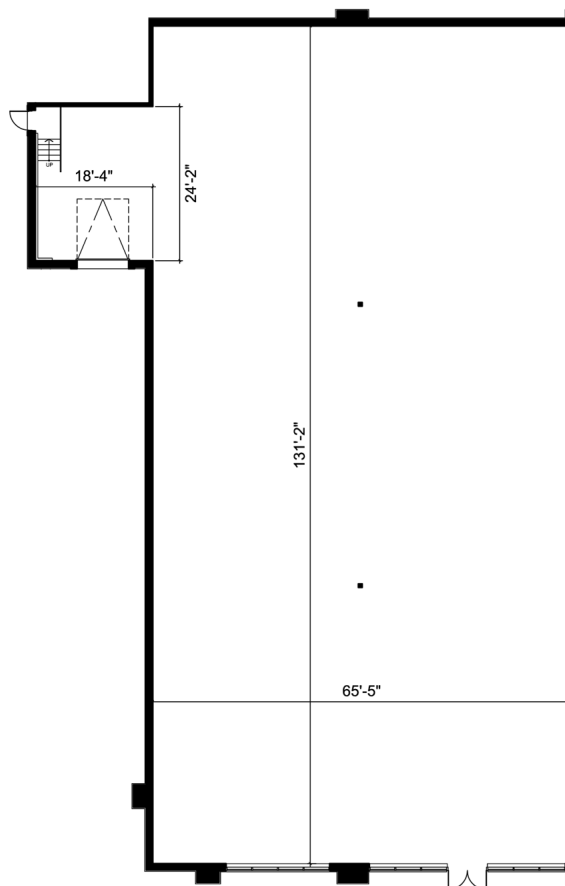

KEY PLAN

0 10 50 FT.

UNIT 1
RENTABLE AREA = 9,460 SF
AREA PROVIDED BY METRUS

LOCATION:

181 Green Lane East
Town of East Gwillimbury

South-east corner of Yonge St. & Green Lane



FOR MORE INFORMATION, PLEASE CONTACT:

Antoinette Grossi
Director of Leasing

905.669.9714
agrossi@metrusproperties.com

The information combined herein has been obtained from source deemed reliable; however, we do not warrant its accuracy. The information herein may change from time to time without notice. The property may be withdrawn from the market without notice.