

Office - Floor Plan

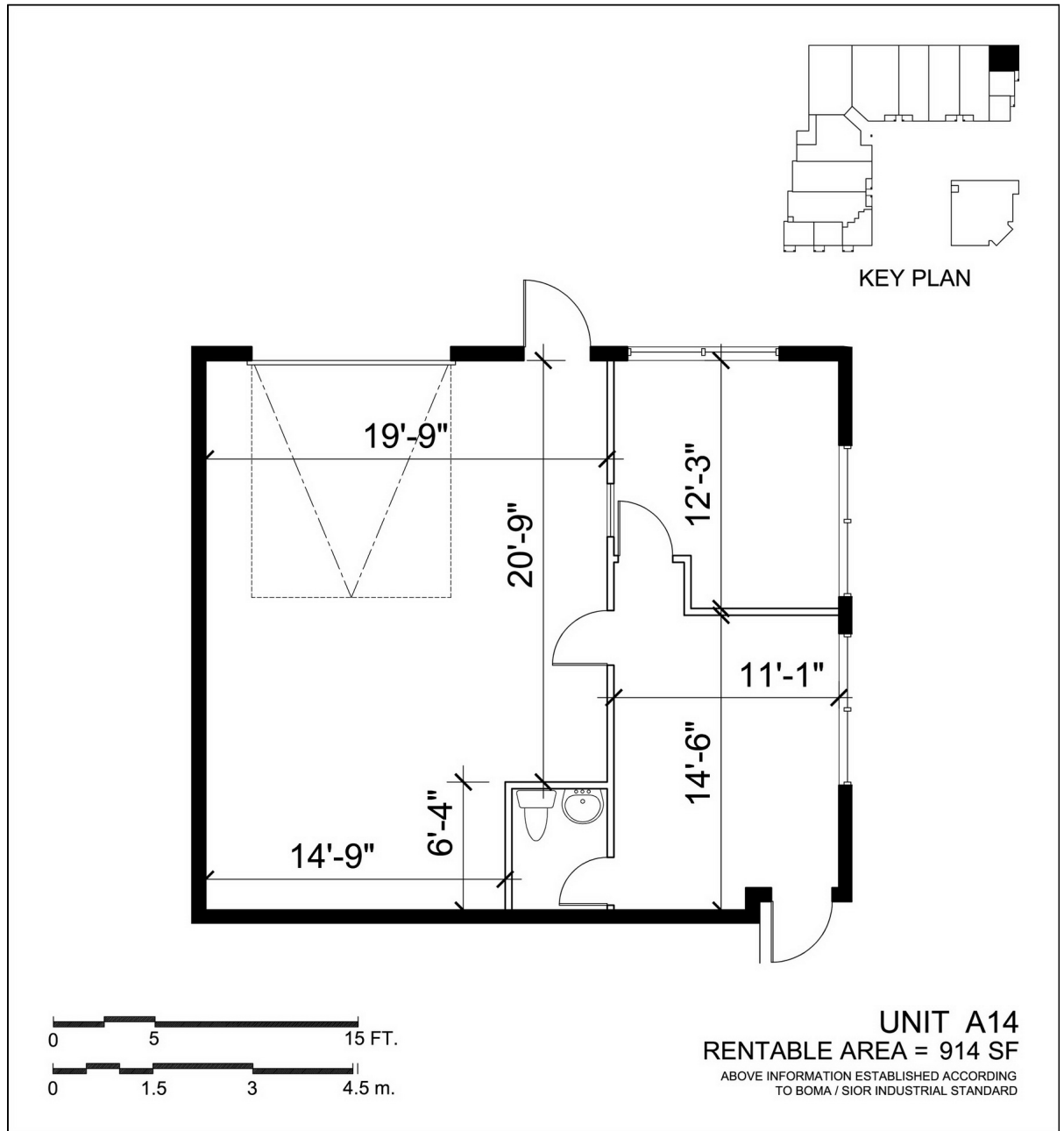

LOCATION:

10 West Pearce Street
Town of Richmond Hill

Corner of Leslie Street and West Pearce Street

AVAILABLE SPACE:

914 sf

ASKING PRICE:

\$12.50/sf



FOR MORE INFORMATION, PLEASE CONTACT:

Gabrielle Mair
905.669.9714

905.669.9714
gmair@metrusproperties.com