

Industrial - Floor Plan

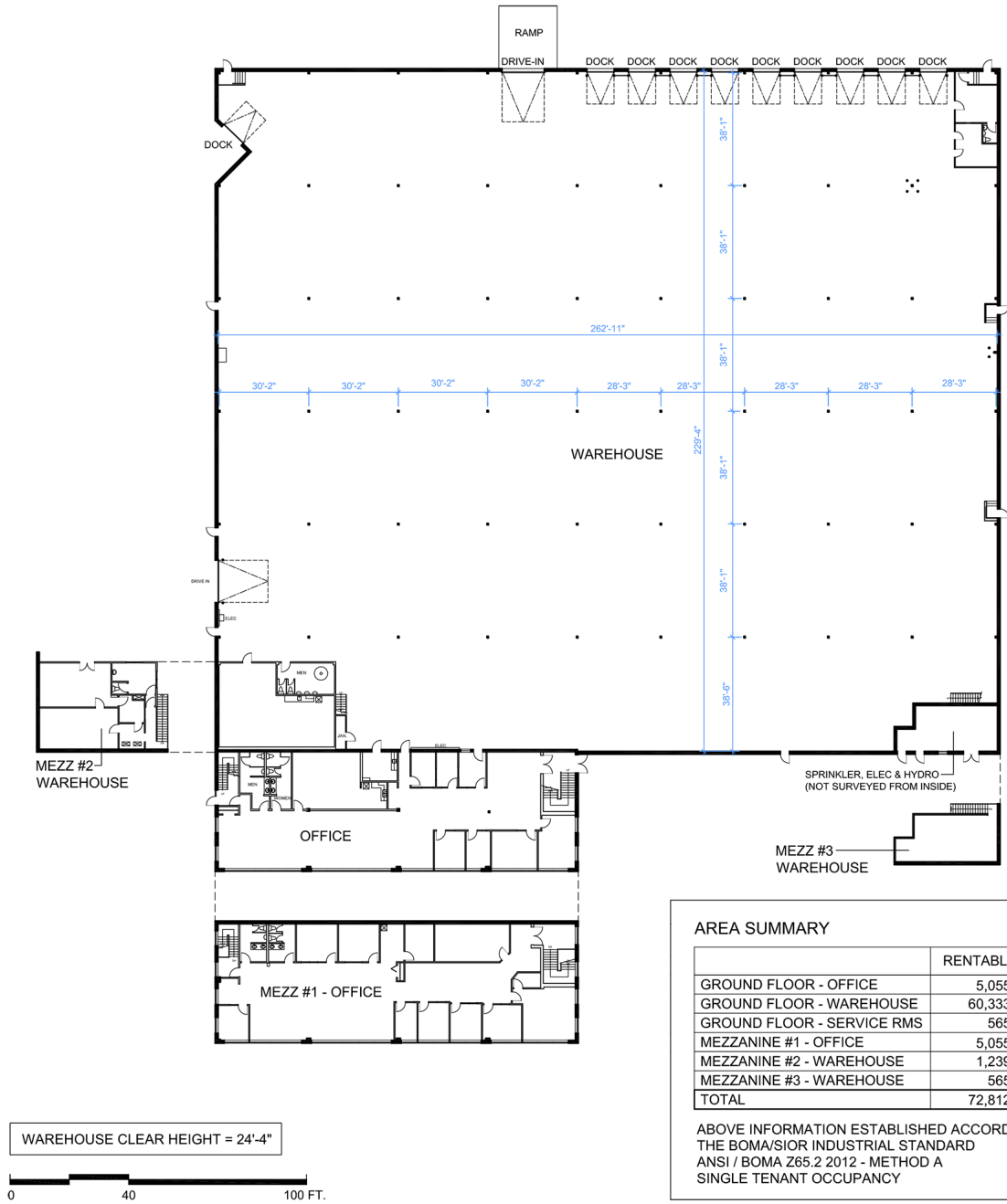

AREA SUMMARY

| | RENTABLE AREA |
|----------------------------|--------------------|
| GROUND FLOOR - OFFICE | 5,055 S.F. |
| GROUND FLOOR - WAREHOUSE | 60,333 S.F. |
| GROUND FLOOR - SERVICE RMS | 565 S.F. |
| MEZZANINE #1 - OFFICE | 5,055 S.F. |
| MEZZANINE #2 - WAREHOUSE | 1,239 S.F. |
| MEZZANINE #3 - WAREHOUSE | 565 S.F. |
| TOTAL | 72,812 S.F. |

ABOVE INFORMATION ESTABLISHED ACCORDING TO THE BOMA/SIOR INDUSTRIAL STANDARD ANSI / BOMA Z65.2 2012 - METHOD A SINGLE TENANT OCCUPANCY

LOCATION:

76 Wentworth Court
City of Brampton

North of Highway 407, East of Goreway Drive



FOR MORE INFORMATION, PLEASE CONTACT:

Gabrielle Mair
 Director of Leasing

905.669.9714
gmail@metrusproperties.com